

## NEW 180° Bolt-on 4D adjustable hinge

BOLTONHD-4D- (Patented)



180° hinge which can quickly be mounted without any welding being required. It offers all advantages of the GBMU4D range: vandal-proof, adjustment of height, depth and distance between gate and post, left/right interchangeable so it can be used for both left and right turning gates. BOLTONHD-4D is available in M12 and M16, and always in 2 versions: one with Quick-Fix on both sides and one with Quick-Fix on the post, and on gate side a bolt through fixing for gate frames from 40 to 60 mm.

### Color options

ALUM 6005 7016 9005

### Specifications

- ✓ Easy to fix with Quick-Fix or bolt through fixing
- ✓ Vandal-proof eyebolt & crossbolt
- ✓ 180° opening
- ✓ Hot-dip galvanized eyebolt and crossbolt
- ✓ Max width of the gate: 2000 mm

### Hinge parts



BOLTON-U-  
P. 110



BOLTONHD-G-  
P. 110



1034HDGA-  
P. 115

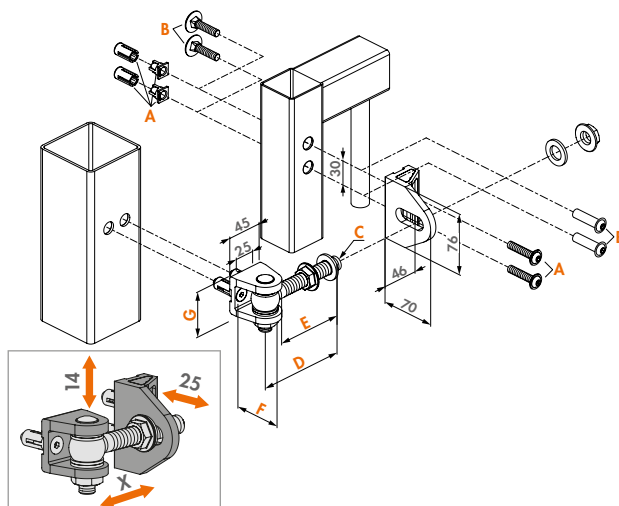

### Order codes & Dimensions

	kg	A	B	C	D	E	F	G
BOLTONHD-4D-12-QF-90	100	Quick-Fix		M12	90	70	42	35,5
BOLTONHD-4D-12-4060-90	100		Bindrabus	M12	90	70	42	35,5
BOLTONHD-4D-16-QF-110	200	Quick-Fix		M16	110	85	50	46,5
BOLTONHD-4D-16-4060-110	200		Bindrabus	M16	110	85	50	46,5

